

GO ECO: DUNE Laptop Stand

Manufactured from sustainable timber.
Designed to be easily dismantled for refurbishment, repair or recycling.
RPET case made from recycled plastic bottles.
Water based and environmentally safe finish.
Environmentally conscious non-toxic plastic components.
Calming natural materials.

As with all natural materials please avoid moisture, humidity and extreme temperature changes.

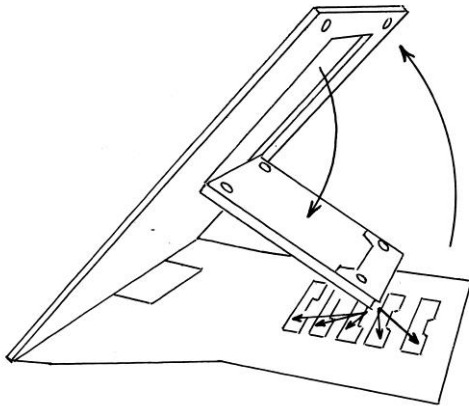

As with all laptop stands. This product is designed to be used with an external keyboard and mouse.

Another great solution from Ergonomic Cafe Ltd.

www.ergonomiccafe.com

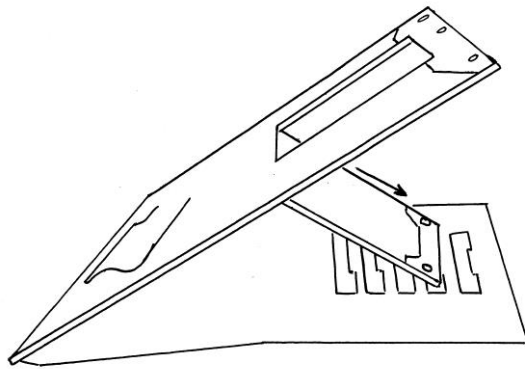

Ensure the arm is correctly fitted in chosen slot

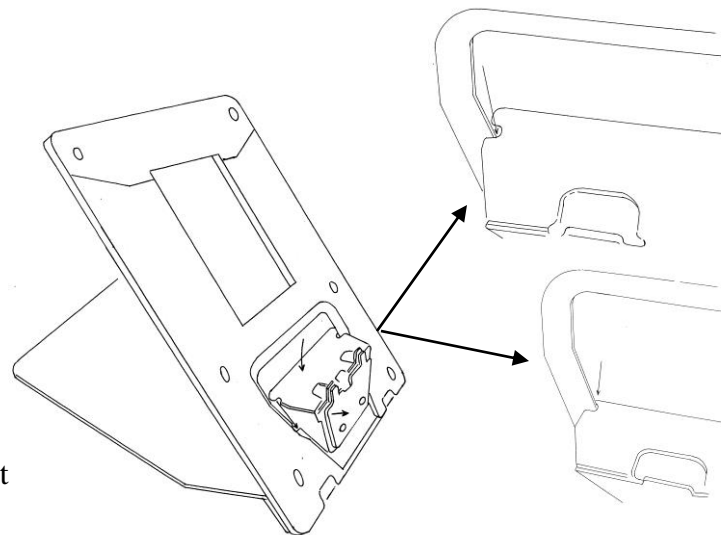

Ensure both sides are secure in the slots.

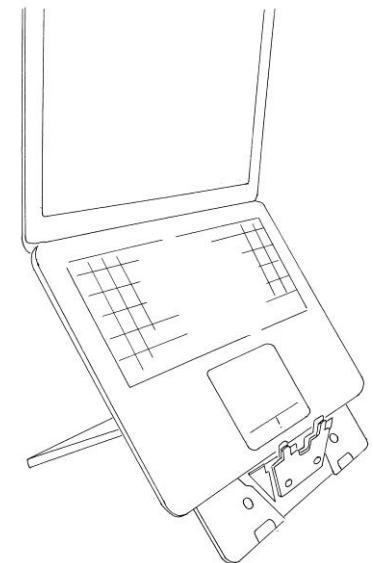

Always remove device before adjusting.